

SALES DRAWING

SALES DRAWING

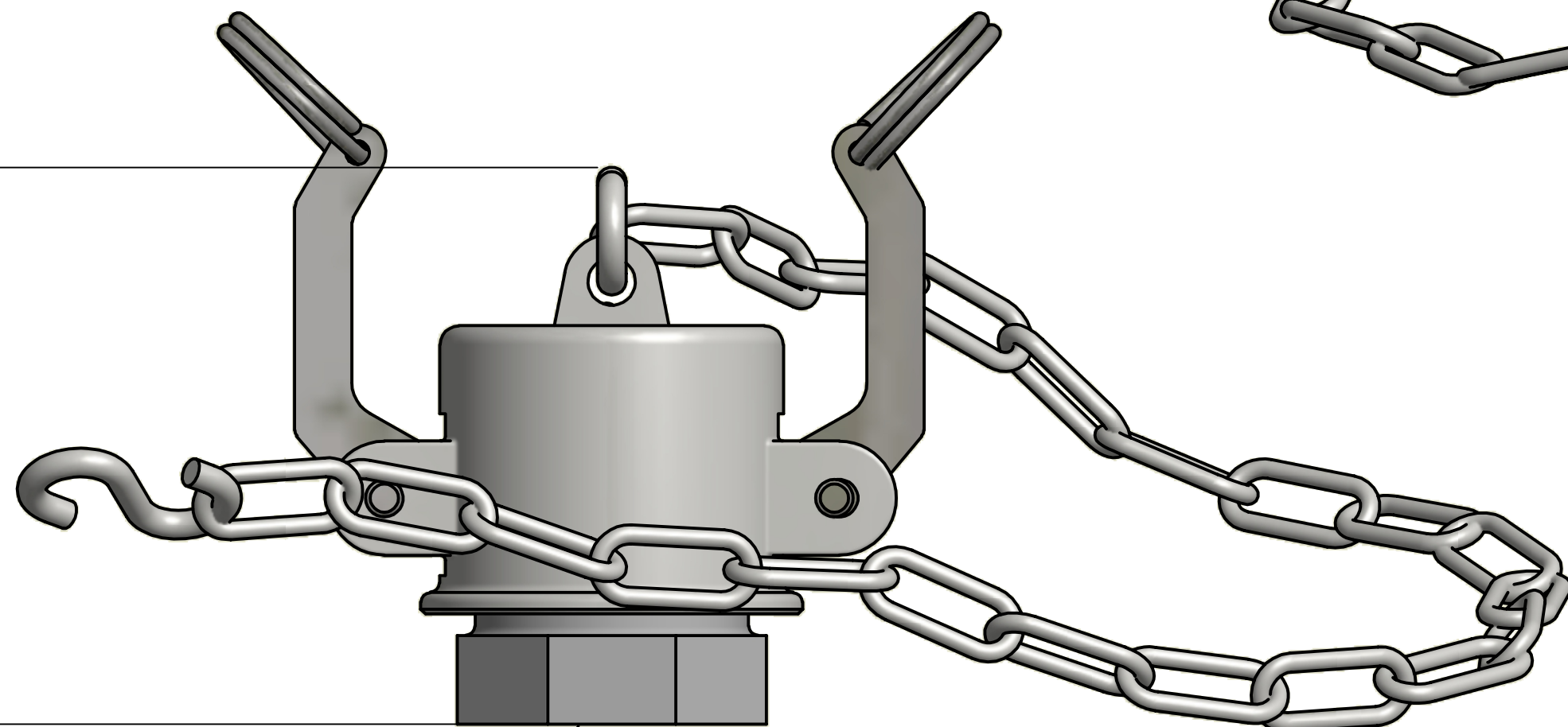

1 1/4-11.5 NPT

(3 5/8)

21 LINKS OF 1/8" 18-8 SS CHAIN
APPROXIMATE LENGTH IS 19"

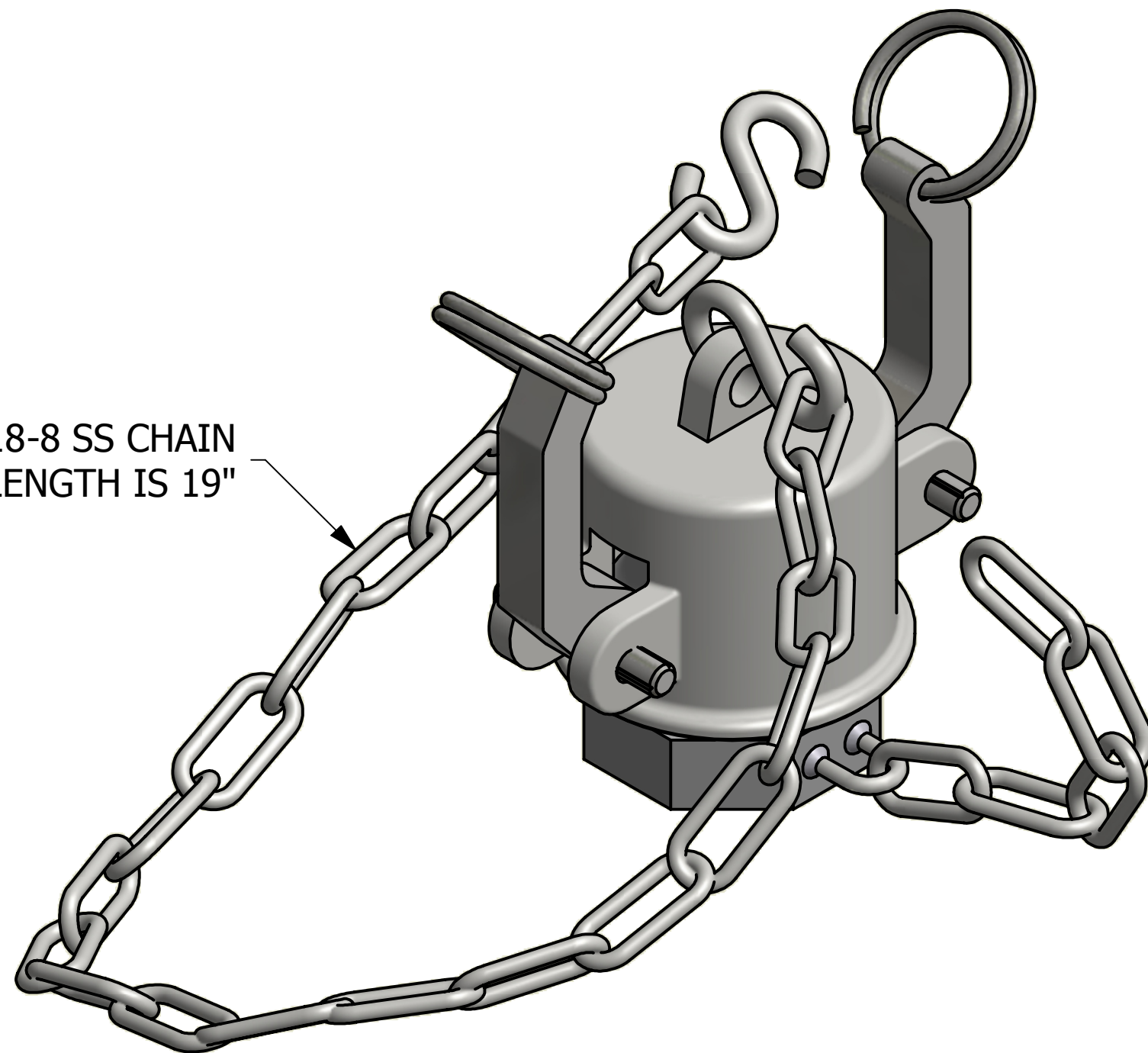

ISOMETRIC VIEW

NOTE:
GASKET IS BLACK VITON® GF-600S.

B	RJP	4-9-15	SC25SHS TO SC316SHS UPDATED K1250SDC12A & K125SFPA	
A	RJP	3-3-15	RELEASED FOR PRODUCTION	
REV	BY	DATE	DESCRIPTION	
<div><div><div></div><div></div></div><div>SALCO PRODUCTS, INC.</div></div>				
PART NAME: TOP FITTING ASSEMBLY 1 1/4" THREAD ON				
MATERIAL: 316 SS				
PROJECT #:		R150129	SHEET #:	1 OF 1
DRAWING #:		C40804	PART #:	K1250SUFP12A

UNLESS OTHERWISE SPECIFIED DIMENSIONAL TOLERANCES FRACTIONAL: $\pm 1/16$ X.XX: $\pm .03$ X.XXX: $\pm .015$ ANGLE: $\pm 1^\circ$ DEBURR ALL SHARP EDGES. ALL MACHINED SURFACES TO HAVE A 125 RMS FINISH UNLESS NOTED OTHERWISE. THIRD ANGLE PROJECTION	DRAWN BY:	RJP
	CHECKED BY:	CHL
	PROTOTYPE BY:	RJP
	PROTOTYPE DATE:	2/4/2015
	APPROVED FOR PRODUCTION BY:	CHL
	PRODUCTION DATE:	3/3/2015

THIS PRINT, PROPERTY OF SALCO PRODUCTS INC., CONTAINS PROPRIETARY INFORMATION
AND MUST NOT BE COPIED, REPRODUCED, OR USED DETRIMENTALLY TO OUR INTEREST.